

Evok BTW Freestanding Bath With Upstand

22161A-1UP-0

**BEFORE YOU BEGIN**

- 1) The upstand is an optional feature of New Zealand version Evok BTW Freestanding baths.
- 2) Please carefully read these instructions together with the Kohler Freestanding BTW bath Installation and care guide to familiarize yourself with the required tools, materials and installation sequences.
- 3) The installation assumes that the mounting walls are plumb and the floors are level.
- 4) The installation shall only start after all necessary plumbing is completed.
- 5) All installations must comply with council and local authority by-laws.

# UPSTAND INSTALLATION

- 1) Install the bath with upstand to the wall as shown in figure 1.
- 2) Install a packer (suggest 8mm thickness for 10mm wall board) between the wall frame and the upstand to ensure the front face of the upstand is flush with the surface of the wall board.
- 3) Apply silicone sealant as shown to form a watertight seal between the upstand and the wall board.
- 4) Apply a waterproof membrane to the walls, including onto the bath upstand. Finish the wall with tiles or another impervious surface.

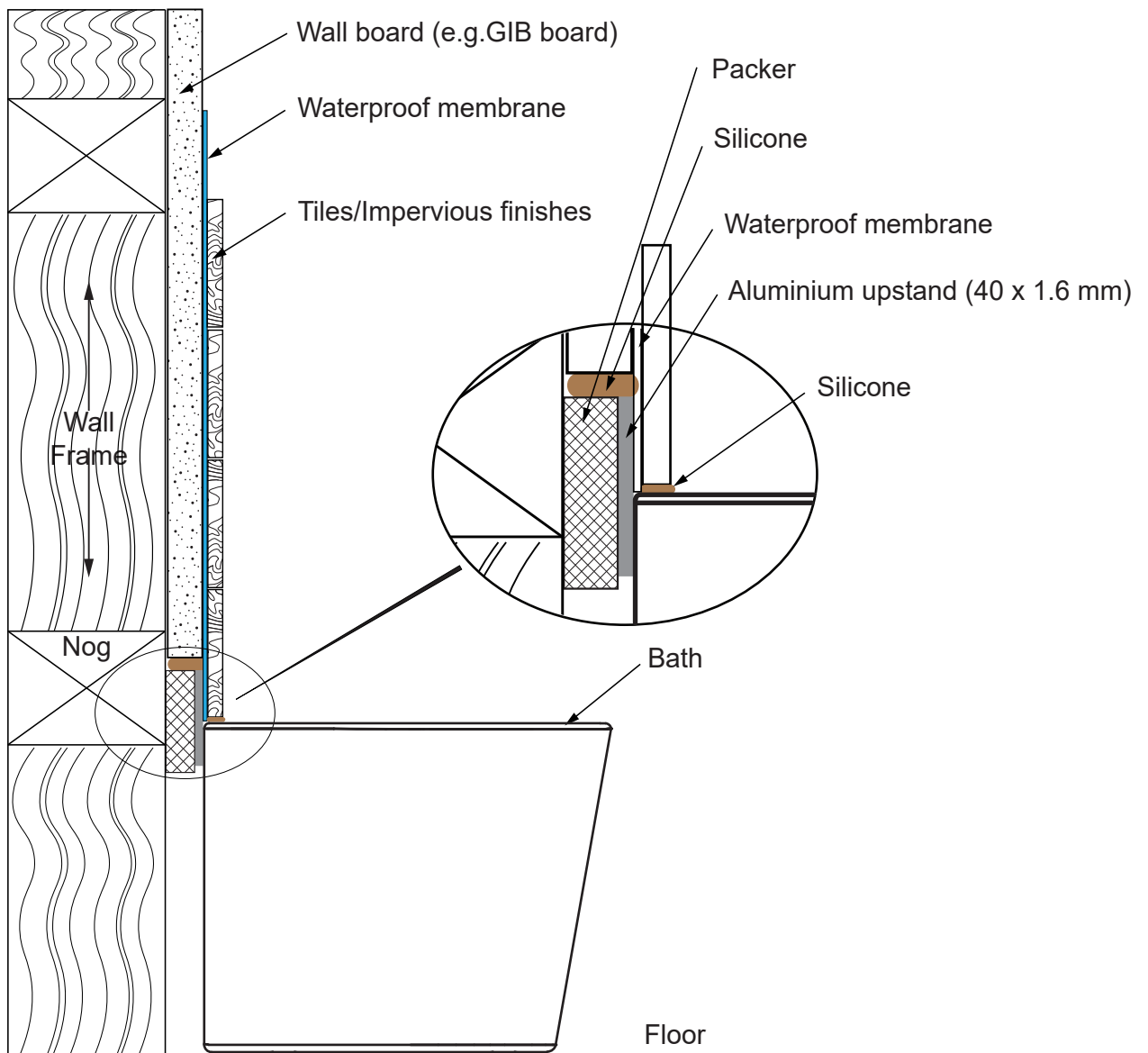

Figure 1