

Features:

- Vanity top has unique off-set design
- Soft closing & smooth sliding single drawer
- Hafele premium runners supplied
- Concealed upper drawer for easy-to-reach items
- Highly water resistant for product durability
- Cabinetry designed and manufactured in New Zealand

Material:

- Vanity top: Polymarble
- Cabinet: Veneered hardwood plywood, grade A, 18mm thick

Included Components:

- Toobi 900mm vanity top
- Integrated overflow & overflow kit
- Toobi II cabinet with top utility drawer



Tapware and waste not included



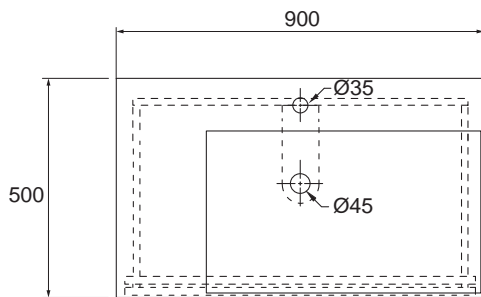

Technical Details:



Available Colors/Finishes

Color tiles intended for reference only.

Color	Code	Description
	25811A-NA	Slate
	25812A-NA	Midnight
	25813A-NA	Sand Dune

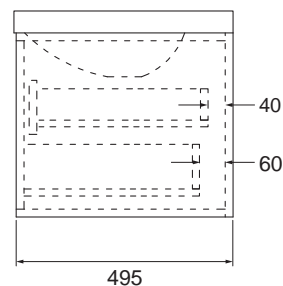
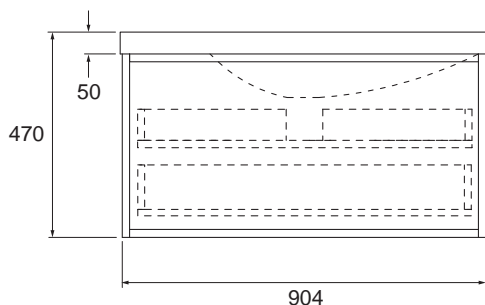

Installation Notes:

- For best results, the walls must be square, plumb and level.
- Cabinets must be fixed to nogs in the wall.
- The Kohler Click-Up waste 7119A-* is a suitable waste with Kohler Toobi vanity tops.

New Zealand

0800 100 382
kohler.co.nz

Australia

1800 364 533
kohler.com.au

Kohler reserves the right to make revisions without notice to product specifications.
For the most current specifications, please visit our website.