

## BEFORE YOU BEGIN

Thank you for purchasing a quality KOHLER product. To enjoy the full potential of your new product, please take time to read this guide thoroughly, having done so, keep it handy for future reference.

The following pages aim to provide comprehensive installation instructions, plus advice on how to care and maintain your product.

We recommend that the unit is installed by a qualified shower installer or Plumber.

### General:

1. Read all of these instruction and retains this guide for later use.
2. Pass on this guide in the event of change of ownership of the installation site.
3. Follow all warnings, cautions and instructions contained in this guide.
4. Remove all protective plastic bag/tapes from the sink before installation.



IMPORTANT

Read all instructions carefully before starting the installation to ensure the best possible results. It is the responsibility of the installer to ensure that the installation complies with council and local authority by laws.



IMPORTANT

Refer to the "Prepare the Kitchen sink" section for cabinet dimensional requirements.



IMPORTANT

Install the sink before installing the countertop.



IMPORTANT

Long screws have the potential to harm neighbouring cabinets. It is essential to use screws that are sufficiently long to adequately secure the support framing, while also being short enough to prevent them from protruding into the walls of adjacent cabinets.



IMPORTANT

Fasteners are not included. The countertop supplier should install anchors into the underside of the countertop.

- Due to the nature of under-mount installations, Kohler Co. recommends that only trained and experienced installers perform under-mount sink installations.
- Use proper fasteners and techniques to ensure that the frame will support a minimum of 136 kg. Locate the fasteners for easy access in the event the sink needs to be removed in the future.
- This sink is intended for installation into a 36" apron sink base cabinet.
- All installation shall be in accordance with the Plumbing Code of Australia (PCA) and AS/NZS 3500.2.

## TOOLS AND MATERIALS REQUIRED:

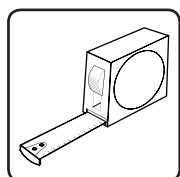

Tape measure

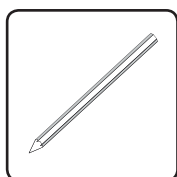

Soft pencil



Disposable gloves

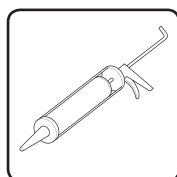

Caulking gun

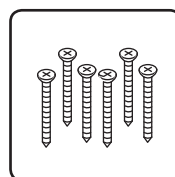

Wood Screws

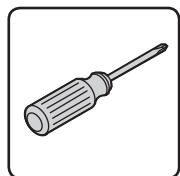

Screw driver

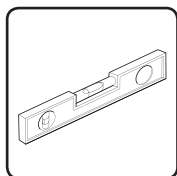

Spirit level

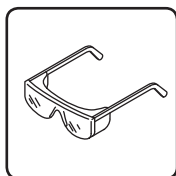

Safety Glasses



Rags

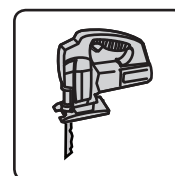

Jigsaw

Additional items:

- suitable support framing
- Material 38 mm max thickness

## INSTALLATION

### 1. Prepare the kitchen sink:

- Cut along the dotted line on the template.
- Position the template on the counter top in the desired location.
- Ensure the template is securely in place.
- Check for adequate clearance between the sink, faucet, and backsplash.
- Verify that the sink will not interfere with the cabinet during installation.
- Trace around the outer edge of the template with a pencil.

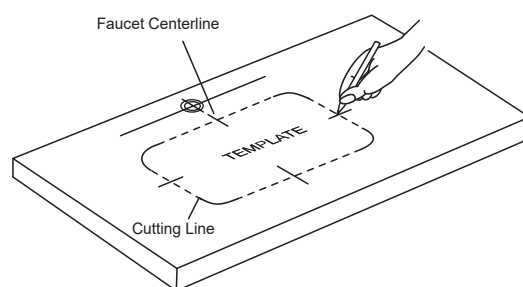

### 2. Cut the countertop:

1. Drill a pilot hole at the center of the cutting line.
2. Cut the outline of the template using a jigsaw.

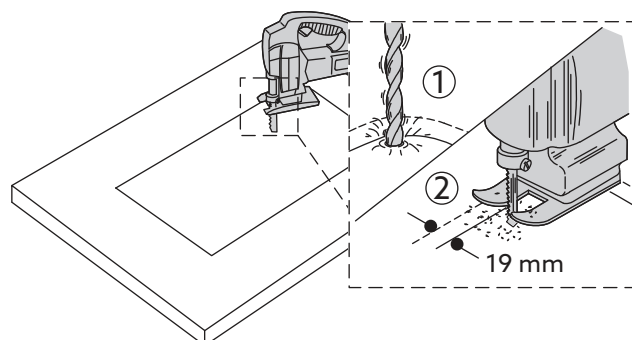

3. Ensure to clean both the top and underside of the counter, as well as the sink rim.

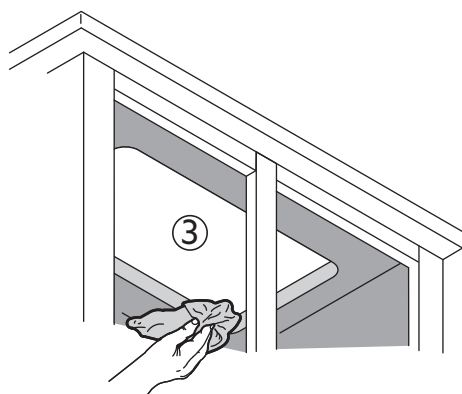

**Optional:** Build a wooden frame that supports the sink. Determine the dimensions of your sink by measuring it.

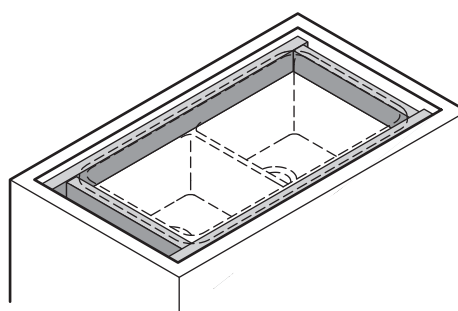

## INSTALLATION

### 3. Install the mounting clips:

- Secure the mounting clips by evenly spacing them on the underside of the countertop and attach them loosely.

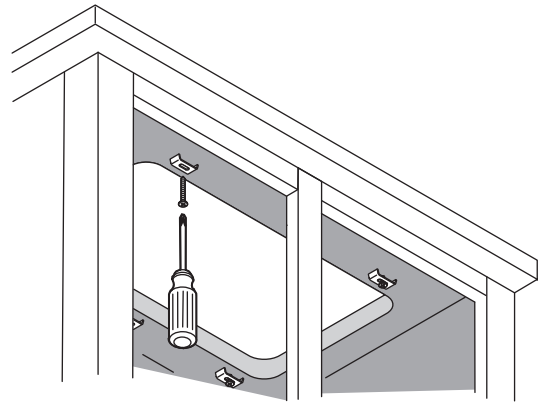

### 4. Applying silicone on sink:

- Apply silicone sealant or rubber sealant to the inner rim of the sink.

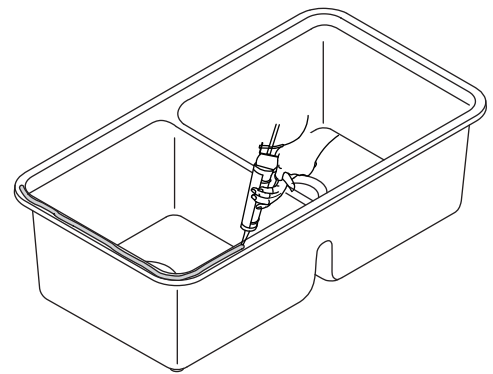

### 5. Fastening mounting clips:

- Lift the sink into place.
- Rotate the clips and tighten evenly.

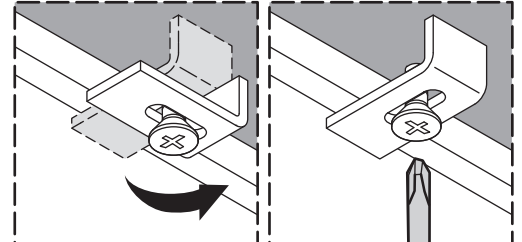
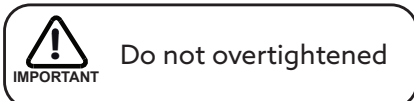

### 6. Cleaning silicone sealant on sink:

- Use a dry cloth to wipe away any excess sealant.
- Verify that there are no gaps.
- Allow the sealant to cure for at least 30 minutes.

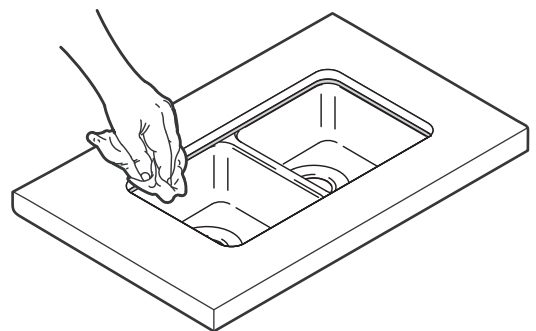

## INSTALLATION

### 7. Kitchen sink waste Installation:

- Install the faucet and the Kitchen waste strainers.
- Recommended waste:
- Bowl A: 1216931 (Sink waste outlet).
- Bowl B: 1216931 (Sink waste outlet).

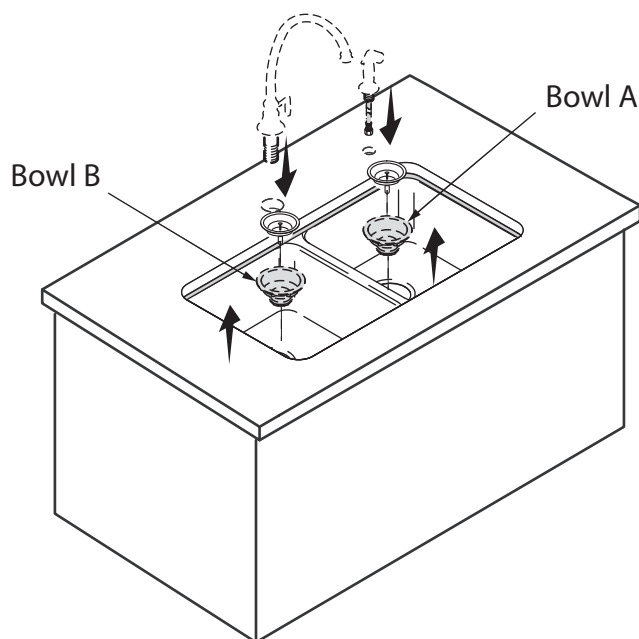

### 8. Complete the Installation:

- Complete the faucet and drain connections.
- Run water and check for leaks.

## SPARE PARTS

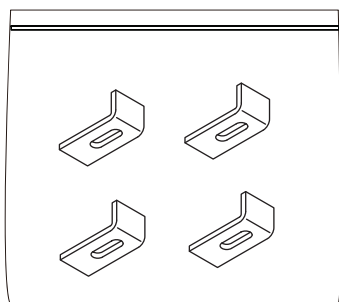

**Clamp Accessory Pack  
(1193643)**

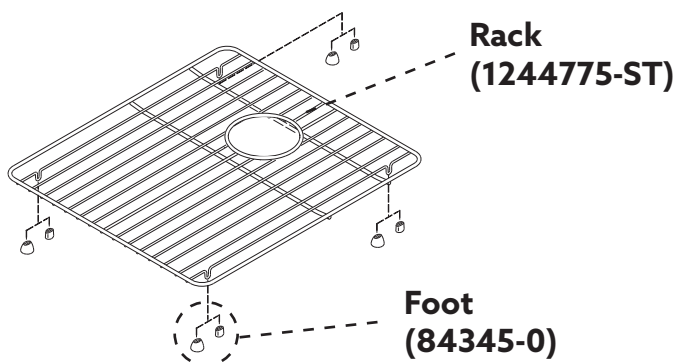

**Basin Rack  
(5656-ST)**

## CONTACT AND WARRANTY INFORMATION

**NEW ZEALAND**  
Kohler New Zealand  
Ph: 0800 564 537  
[www.kohler.co.nz](http://www.kohler.co.nz)

**AUSTRALIA**  
Kohler Australia  
Ph: 1800 564 537  
[kohler.com.au](http://kohler.com.au)

For warranty information, please visit our website.