

Included Components

- Installation hardware

Features

- Polished chrome • Metal construction • Durability • No visible fixings

- Double robe hook
Kohler: 16256-CP

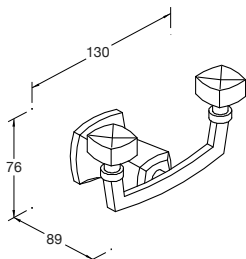

- Valet - 457mm
Kohler: 16257-CP

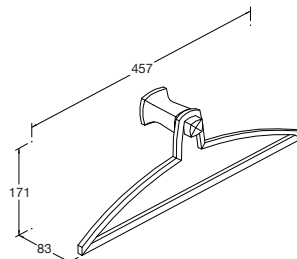

- Towel ring
Kohler: 16254-CP

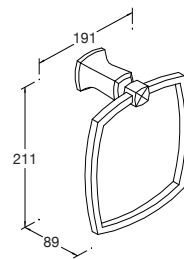

- Horizontal toilet tissue holder
Kohler: 16265-CP

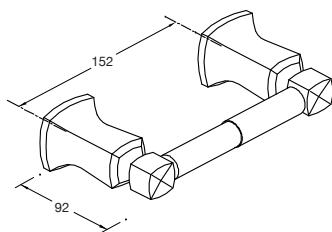

- Vertical toilet tissue holder
Kohler: 16255-CP

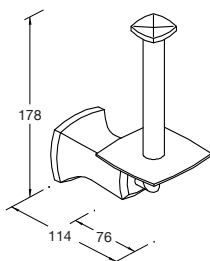

- Tumbler with holder
Kohler: 16260-CP

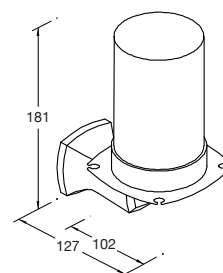

- Double towel bar - 610mm
Kohler: 16253-CP

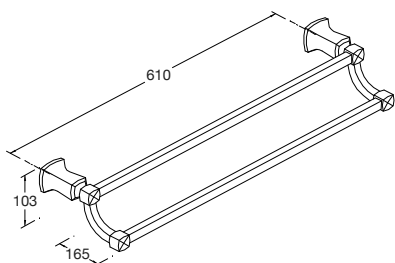

- Glass shelf - 665mm
Kohler: 16258-CP

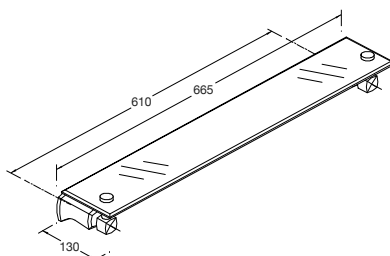

- Towel bar - 457mm
Kohler: 16250-CP

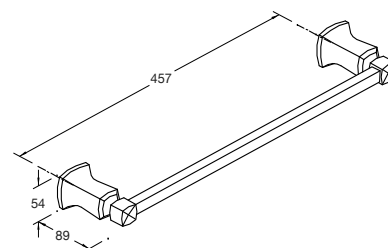

Installation Notes:

- In an effort to make installation quick and easy, Kohler accessories are shipped with a hex key wrench, anchors and pre-assembled parts.
- While it is possible to mount them to any surface, a stud mounted product will yield the best results.