

INSTALLATION

General

1. Make sure that the basin is installed by a competent installer.
2. Before installation carefully inspect the new item for any signs of damage.

Install the Towel Bar (not included with Ove)

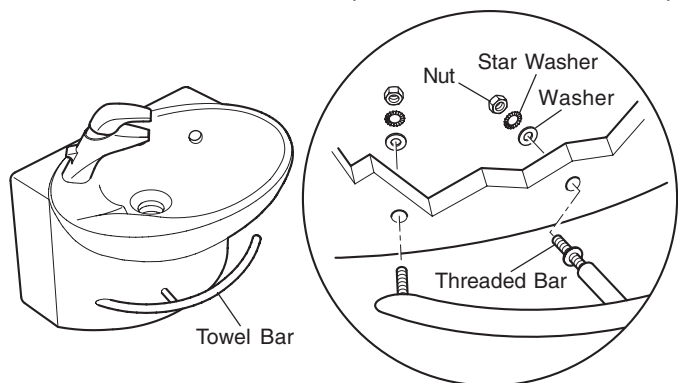

Note! Handwash basin may differ from the one shown.

1. Fit the threaded bar and the threaded end of the towel bar through the holes in the basin.
2. Install the washers, the star washers and the nuts (supplied) to secure the towel bar in place. Do not overtighten.

Install the Handwash Basin

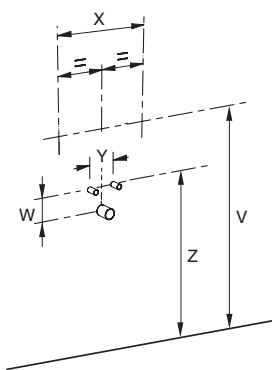

Description	Model No.	W	X	Y	Z	V
Escale	19033W	50 mm	226 mm	80 mm	640 mm	735 mm
Freelance	19456D	50 mm	200 mm	80 mm	640 mm	770 mm
Presqu'île	19079	50 mm	180 mm	80 mm	640 mm	775 mm
Ove	19958W	50 mm	180 mm	80 mm	640 mm	780 mm

1. Install the services.
2. Make sure that the hot and cold water supply pipes and the waste are installed correctly.
3. Place the basin in position and make sure that it is level.
4. Mark the position on the wall for the attachment bolts.

Caution! Make sure that you avoid hidden cables and pipes when drilling holes in the wall.

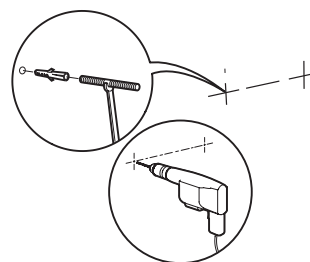

5. Remove the basin and drill the fixing holes.
6. Fit the wall plugs and the attachment bolts (supplied).
Note! Inlet isolating valves must be installed in the Hot and Cold water supplies.
7. Fit the tap to the basin in accordance with the manufacturer's instructions.
8. If necessary, apply silicone sealant to the back of the basin.

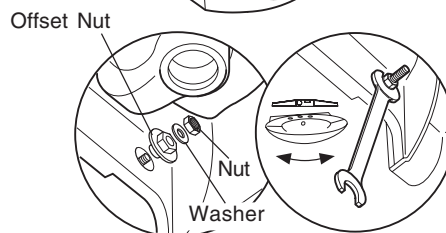
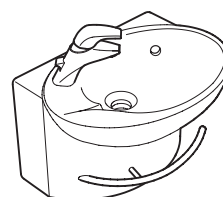

9. Fit the basin in position over the attachment bolts.
10. Adjust the offset nut until the basin is level.
11. When the basin is level, fit the washers and the nuts (supplied) to secure in place.
12. Remove any excess silicone sealant.

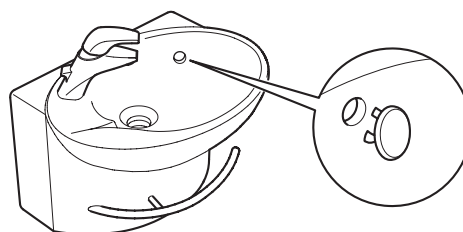

13. Place the overflow cover over the hole in the basin, making sure it is fitted securely.

Finish the Installation

1. Install the drain in accordance with the manufacturer's instructions.
2. Connect the hot and cold water supplies.
3. Ensure that all the connections are tight.
4. Turn on the water supply and check for any leaks.